



# Greece Boat Booking

YOUR SAILING VACATION IN GREECE



## Hanse 588 Medseatation skippered

A sailing yacht that is as pleasurable to sail in, as is to live in, and glaze at!

### SPECIFICATIONS

YEAR  
2019

LENGTH  
16.69 m / 54.76 ft

BEAM  
5.20 m / 17.06 ft

DRAFT  
2.65 m / 8.69 ft

### ACCOMMODATION

GUESTS CABINS WC  
**6 4+1 4**

CABIN CONFIGURATION  
3 Double-bed guests cabins inside  
1 Double-bed crew cabin inside  
1 Bow crew cabin outside

### DETAILS

All cabins are air-conditioned and have en-suite facilities

### CHARTER RATES

LOW SEASON (April, May, October, November)  
€ 7500 / week

MID SEASON (June, September)

€ 10 910 / week

HIGH SEASON (July, August)  
€ 11 800 / week

### NOTE

Price include: skipper, end cleaning, linen, pillows and blanket , bath towels (set of small and big), beach towels, 2 \* SUP/Kayaks, Children's water ski, snorkeling and fishing equipment, yacht's 3rd party insurance



# Greece Boat Booking

YOUR SAILING VACATION IN GREECE

www.greeceboatbooking.com  
info@greeceboatbooking.com  
+42 0734867610

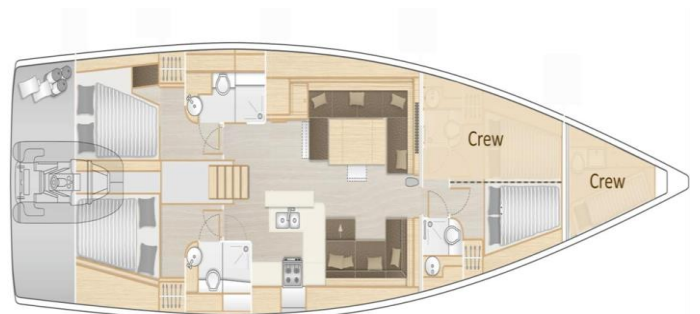





## S/Y Hanse 588

### DESCRIPTION

Words can not put justice to this magnificent 17m production line sailing yacht. Judel Vrolijk once again designed **a yacht that is as pleasurable to sail in, as is to live in, and gaze at!**

She was ordered to build by a caring owner, wishing to offer his guests an uncompromising sailing vacation. Understanding that **comfort, beauty, functionality and performance**, must all co-exist in perfect equilibrium.

Medseation has been designed and equipped for the sailing enthusiast on a family or couples summer holiday. Maintaining good sailing speeds in any wind force and direction, those that love to sail will be pleasantly surprised by her performance. Meanwhile, those that are less excited by such thrills, will enjoy comfortable living, true relaxation and endless fun under the sun. Surely, all will be impressed by her absolute yachting style and her smooth glide. Indoors, she is welcoming, with her luminous, modern and spacious design. Salon and galley are well over full standing height, as are guest cabins, which feature en suite facilities and independent air-conditioning. On deck, her twin-table cockpit is designed for ease of access and space. The tables drop, instantly converting the cockpit to lounging area. Featuring a well designed hard top, the cockpit is fully sheltered from the sun and the elements at all times. With the tender tucked below decks in the dinghy garage, the rest of the deck is bloat free, allowing for full enjoyment, with sun cushions and beanie bags that can be used both at anchor, as well as underway. Her real heartbeat, however, is her crew. With ample experience in sailing and in yachting around the Greek isles, her highly professional skipper and hostess take true pleasure in the art of hosting and in showing their guests good times. Mostly interactive, though discreet when required, they will safely navigate Medseation and her passengers through the highlights and the secret spots of the vast Hellenic archipelago.

### ADDITIONAL SPECIFICATIONS

#### ENGINE

1\*110 HP

#### DIESEL CAPACITY

520 l

#### CRUISING SPEED / MAX SPEED

8 Knots / 9 Knots

#### DIESEL CAPACITY (lit)

15 Lt/hr

#### WATER CAPACITY

770 l

### EQUIPMENT LIST

#### ACCOMODATION

6 auests in 3 double cabins. all fully air-conditioned with en-suite facilities

#### GENERAL AMENITIES

Smart TV in saloon, Bluetooth sound system (indoors and outdoors speakers), Water maker (180lt/hr), Onboard Wi-Fi internet access (optional), Full A/C, Code 0 light wind sail (optional extra), Twin steering stations with B&G chart plotters and instruments on both sides, radar, mast lights, underwater lights, fully

equipped galley, USB charging across the boat, deck lounging cushions

#### TENDER & TOYS

20hp 4pax tender stored in dinahv aaraae. 2 X Stand Up Paddle Boards. convertible to kavaks. Fishina aear (1 fishina rod and lures). Waterski and tube for children, Snorkeling gear (children's sizes also available)

#### CREW

Consisting of 2: Skipper & Hostess in separate compartment