

## Ferretti 53 FLYBRIDGE

The Ferretti 53 offers luxury, comfort and speed together with safety at sea. She has a sizable interior with two seating areas and a direct exit to the fly-bridge sun-bed area. Glass walls between the interior and cockpit can be removed to maximise interaction between the interior and exterior.

All areas are equipped with a sound system for entertainment. Her spacious and luxurious cockpit can also be used for gatherings, activities or relaxation. High sidewalk edges will guide you safely from the cockpit to the front sun-bed area. The Ferretti 53 has three spacious cabins, with two ensuite bathrooms, that can accommodate up to six guests with ease.



Overview



Flybridge & Rear Deck



**Salon & Master Stateroom**



**Master and VIP cabin**

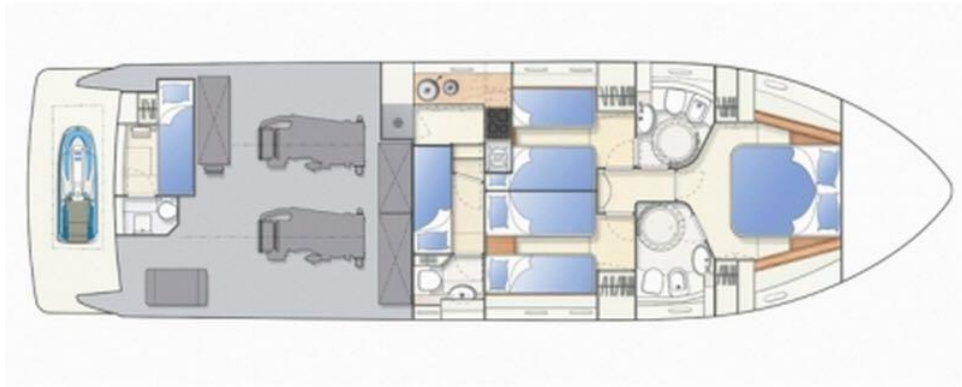

**Layout**

## **SPECIFICATIONS / FEATURES**

### **Technical data**

Builder: Ferretti  
Model: 53 Flybridge  
Year of built: 2007  
Total yacht refit: 2019  
Max. Cruising Capacity: 12 pax (10 guests- 2 crew)  
Max. Sleeping Capacity: 6 pax (6 guests- 2 crew)  
Length overall (incl. pulpit): 55 ft. (18.51 m.)  
Beam: 14,24 ft. (4.70 m.)  
Engines: Caterpillar 660 (2 X 660mhp)  
Maximum Speed: 32 knots  
Cruising Speed: 26 knots  
Fuel capacity: 2500 lt  
Water capacity: 1000 lt  
Generator & 220volt available in all areas of yacht  
Power inverter

### **Facilities**

Cabins: 3  
Berths: 6 (1 double + 4 singles)  
Baths: 2  
Showers: 3  
Flybridge Sunbed  
Bow sunbed  
Fridges: 3 (kitchen, salon & Flybridge)  
Freezer: 2  
Combination microwave/ conventional oven/ grill/ BBQ  
TV: 2 TFT Displays  
Full A/C system: 1+2 (main deck & 3 cabins)  
Safety Box  
Hot and cold transom shower  
Diving stairway  
Tender  
Fully equipped navigation instruments, Radar, auto-pilot  
Fully equipped sound system Radio/CD/USB, subwoofer  
Flybridge sound system  
Wireless music control from your Smartphone or Apple device (iPhone, iPod, iPod, mini iPad, Mac)  
Safe corridor for children